

# Options & Accessories

## Industrial Thermometers

### Stem Materials

Most Trerice Industrial Thermometers are furnished standard with an aluminum stem. Brass and 304 stainless steel stems are optionally available. An air-duct stem, provided with a 3" O.D. reversible aluminum flange (mounted using three sheet metal screws) and perforated aluminum guard, will deliver maximum sensitivity in air ducts. Air-duct stems are available on Adjustable Angle Industrial Thermometers and Econo Thermometers. Please consult the "How to Order" section of the appropriate product data page.

### Integrated RTD "Plus" Option (RTC/RTM)

Most Trerice Industrial Thermometers can be ordered with a "Plus." The "Plus" being an internally mounted 100Ω or 1000Ω RTD, allowing for remote temperature monitoring, while simultaneously providing local indication. This patented\* dual sensor design eliminates the need for additional instrumentation when designing a system to include both mechanical and electronic temperature sensing. Please order using option codes **RTC** (100Ω RTD) or **RTM** (1000Ω RTD).

*\*U.S. Pat. Nos. 5,664,885 and 5,769,542.*

### Specifications

| Sensor Temperature   | Accuracy                                       | Electrical Connection                                | Maximum       |
|--|--|--|---------------|
| International grade thin film platinum, 3-wire 100Ω or 1000Ω RTD<br>$\alpha = 0.00385\Omega/\Omega/^\circ\text{C}$ | $\pm 0.3^\circ\text{C}$ or 0.6% of temperature | Molded cordset with coupling nut and six meter cable | 500°F (260°C) |

### Cases (BPC/CPC)

Industrial Thermometers can be provided with brass or chrome plated cases in 9" (BX) scale size. Please order using option codes **BPC** (brass plated case) or **CPC** (chrome plated case).

### Window (GLW)

Windows are furnished in an ultraviolet protective acrylic or double strength glass. Please consult the table below for available window options.

| Window Material                | Temperature Range   |                    |
|--------------------------------|---------------------|--------------------|
|                                | Up to 300°F (150°C) | Over 300°F (150°C) |
| Ultraviolet Protective Acrylic | Standard            | N/A                |
| Double Strength Glass          | GLW                 | Standard           |

# Options & Accessories

## Industrial Thermometers

### Weatherproofed Cases (WPC)

Trerice Industrial and Econo Thermometers may be sealed for outdoor use, or for use in applications where sprays and washes may come in contact with the thermometer. Please order using option code **WPC** (weatherproofed case).

### Union Connection Bushings

Trerice Industrial Thermometers with brass or 304 stainless steel stems may be installed using a union connection bushing in place of a thermowell. Please consult the table below for bushing item numbers.

**Thermometers with an aluminum stem must always be installed in a thermowell to protect the thermometer stem.**

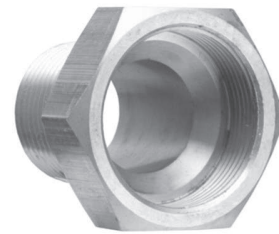

#### Union Connection Bushings

| Material            | Connection | Without Extension Neck | With 2 1/2" Extension Neck |
|---------------------|------------|------------------------|----------------------------|
| Brass               | 3/4 NPT    | 703-05D6               | 082-0013                   |
| Brass               | 1 NPT      | 703-06D6               | 082-0096                   |
| 304 Stainless Steel | 3/4 NPT    | 703-05D6.2             | 082-0013.2                 |
| 304 Stainless Steel | 1 NPT      | 703-06D6.2             | 082-0096.2                 |

### How to Order

Specify the Optional Feature Code at the end of the Instrument Ordering Code.

Sample Order Number: **BX1 1 403 07 WPC**