

Solid State Relay

TA600 Series • AC Output

CONTROLLER ACCESSORIES



TA625 shown

The Trerice **TA600 Series** Solid State Relay has no moving parts, rendering it impervious to shock and vibration, and giving it a virtually infinite life.

HOW TO ORDER

Please order using Item Number **TA610** , **TA625** or **TA640**

All dimensions are nominal. Dimensions in [] are in millimeters.

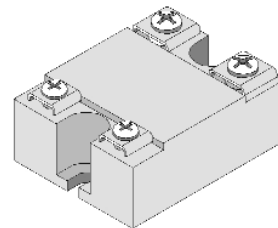
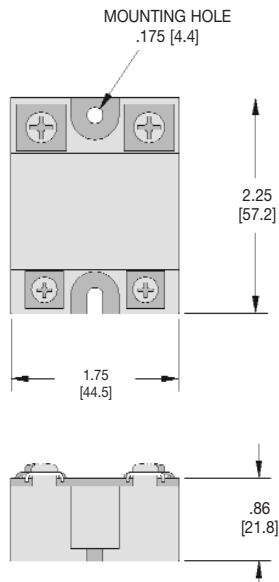

Specifications

Models

TA610: 10 A output
TA625: 25 A output
TA640: 40 A output

Case Epoxy molded with aluminum baseplate

Connection Screw terminals

Input Voltage: 3-32 VDC
 Impedance: 1000Ω minimum
 Must turn on: 3.0 VDC
 Must turn off: 1.0 VDC
 Isolation signal to load: 7000 VDC
 Isolation signal to base: 2500 VDC
 Capacitance signal to load: 15 pt

Output Voltage: 20~300 Vrms
 Typical turn-on voltage: 5 Vrms
 Response time: 0.5 cycle max.
 OFF state DV/DT: 200 V/m sec
 OFF state leakage current: 15 mA
 Max. non-repetitive single cycle surge current: 400 A
 Cycle surge current: 400 A
 IT for fusing (T=8.3 ms): 400 AS
 Peak inverse voltage: 600 Vpk

Ambient Temperature

-20°F (-30°C) to 140°F (60°C)

Approximate Shipping Weight

0.2 lbs [0.09 kg]